



# PRODUCT CATALOG



# CONTACT US

## HEAD OFFICE

Asset Medical Design, Inc.  
İkitelli Organize Sanayi Bölgesi Mahallesi  
17. Cadde No.17, 34480 Başakşehir, İstanbul / Turkey

## USA OFFICE

5965 Village Way, E105-300 San Diego, CA 92130



Please contact us and we will answer your questions  
and help you choose products and solutions that  
meet your needs:

[info@assetmedical.com](mailto:info@assetmedical.com) | Phone: (+90) 212 494 27 27



# TABLE OF CONTENT

05 **Company Overview**

---

06 **History**

---

09 **Export**

---

10 **Make Your Own Design**

---

13 **Products**

---

45 **User's Guide**

---

48 **Notes**

---





**asset**<sup>®</sup>

Design the future

**NeutrArt**<sup>®</sup>

Neutral Displacement Needle-Free Connectors

**FlowArt**<sup>®</sup>

Sterile Infusion Therapy Devices

**SwabArt**<sup>®</sup>

Disinfecting Cap

# COMPANY OVERVIEW

Asset Medical is a leading designer, manufacturer, and provider of IV infusion sets founded in 2009 in Istanbul, Turkey owned by a Dutch private equity firm, General Medical Products BV. Working tirelessly to improve the safety of healthcare practitioners and patients is at the heart of Asset Medical's corporate culture. Asset Medical is specialized in Sterile Infusion Therapy Devices containing Needle-free IV Connectors, Extension Lines, IV Filters, IV Set Accessories, and Disinfecting Caps.

The new state-of-the-art production facilities are located in Istanbul, covering an area of 2.000m<sup>2</sup> with 620m<sup>2</sup> of clean room capabilities. This capacity allows us to produce 60 million heads (individual needle-free valves) and 10 million assemblies, ranking us as one of the largest and most modern Needle-free IV Connector producers worldwide. It aims to offer creative, innovative, cost efficient and high quality Disposable Infusion Products, OEM Products and Components by following the guide institutions and publications in this field.



All the products are designed and manufactured to meet the requirements of relevant International Standards such as:

- ISO 13485
- ISO 14971
- ISO 80369-7
- ISO 80369-20
- ISO 11135
- ISO 11607-1
- ISO 11607-2
- ISO 10993-1
- ISO 15223-1

# 2009

Asset Medical was founded in Istanbul.

**asset**  
Design the future

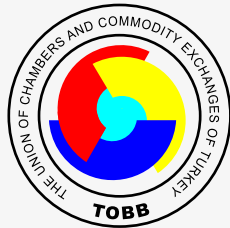

Received "Turkey's one of the fastest growing 100 companies" award from the Union of Chambers and Commodity in Turkey.

# 2017

# 2010

Started to manufacture the FlowArt® Sterile Infusion Therapy Devices, its first patented needle-free valve.

**FlowArt®**



Australian Government

FlowArt® Sterile Infusion Therapy Devices received approval and certification from the Australian Department of Health (TGA).

# 2018

# 2011

Started to export FlowArt® Sterile Infusion Therapy Devices to Italy.

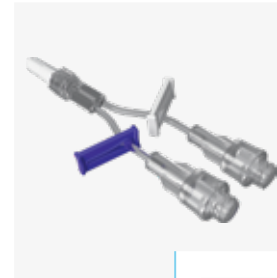

Global launch of the "SwabArt® Disinfecting Caps."

FlowArt® Sterile Infusion Therapy Devices received approval and certification from Brazilian Health Regulatory Agency (ANVISA).

# 2019



# COMPANY HISTORY

## 2012

Received “**Woman Entrepreneur of the Year**” award from Turkish Ministry of Science, Industry and Technology.



T.C. SANAYİ VE  
TEKNOLOJİ BAKANLIĞI

## 2013

Manufactured and launched the first “**one directional needle free valve**”.



## 2016

Acquired by the Netherlands-based “General Medical Devices” and attracted significant capital investment from private equity fund Pera Capital Partners.

PERA  
CAPITAL  
PARTNERS



FlowArt® and NeutrArt® Needle-free Connectors received approval and 510(K) certification by USA Food and Drug Authority (FDA).

## 2020

NeutrArt®

Rapids International expansion and Global launch of the Neutral Displacement NeutrArt® Needle-free Connectors.

## 2021

asset  
Design the future

Based on increasing International demand, Asset Medical quadrupled production capabilities.

## 2022





# WORLDWIDE EXPORT

At Asset Medical, we put great importance on constructing bridges and building lifelong business relationships. Our International strategy is grounded on building long-lasting relationships with our partners and distributors in key geographic locations and supply consistent top-quality products to meet the local demands and requirements. Thanks to our excellent production and logistics planning processes. Along with access to our wide range of top-quality products, our distributors receive full product training, marketing materials, and technical support documents.

Asset Medical typically works with partners to acquire country-specific certifications for our products. In addition, we assist partners in responding to requests and frequently participate in joint marketing campaigns. Asset Medical currently exports to over 40 countries in 5 continents.

- › EC Certificate
- › US Food and Drug Authority (FDA)
- › Australia Therapeutic Goods Administration (TGA)
- › Brazilian Health Regulatory Agency (ANVISA)
- › Saudi Food and Drug Authority (SFDA)





# MAKE YOUR OWN DESIGN



Please describe what kind of IV infusion set you need, we will make a sample for you

22	21	20	19	18	17	16	15	14	13	12	11	10	9	8	7	6	5	4	3	2	1	0	1	2	3	4	5	6	7	8	9	10	11	12	13	14	15	16	17	18	19	20	21	22	
																																													0
																																													1
																																													2
																																													3
																																													4
																																													5
																																													6
																																													7
																																													8
																																													9
																																													10
																																													11
																																													12
																																													13
																																													14
																																													15
																																													16
																																													17
																																													18
																																													19
																																													20
																																													21
																																													22
																																													23
																																													24
																																													25
																																													26
																																													27







# OUR PRODUCTS

## IV Infusion Therapy Solutions

---

NeutrArt® Neutral Displacement Needle-free Connectors  
FlowArt® Needle-free Valves  
FlowArt® I.V. Filters  
FlowArt® Bag and Vial Adapters  
SwabArt® Disinfecting Caps

## OEM Products

---

Needle-free Valve  
Needle-free Valve for Tube Bonding  
Y Site with Needle-free Valve

## Medical Components

---

2 Way Connector  
3 Way Connector  
Male Luer Lock (MLL)  
Slide Clamp  
Female Cap  
Luer Collar



**01**

SECTION

---

# IV INFUSION THERAPY SOLUTIONS



NeutrArt® Neutral Displacement  
Needle-free Connectors



FlowArt® Needle-free Valves



FlowArt® I.V. Filters



FlowArt® Bag & Vial Adapters



SwabArt® Disinfecting Caps



# NeutrArt®

Neutral Displacement Needle-Free Connectors

NeutrArt® is a single-use, disposable connector intended for use with a vascular access device for administration of fluids during IV therapy. Designed with a transparent housing for flush visualization and a flat swabable valve surface to enhance infection prevention.



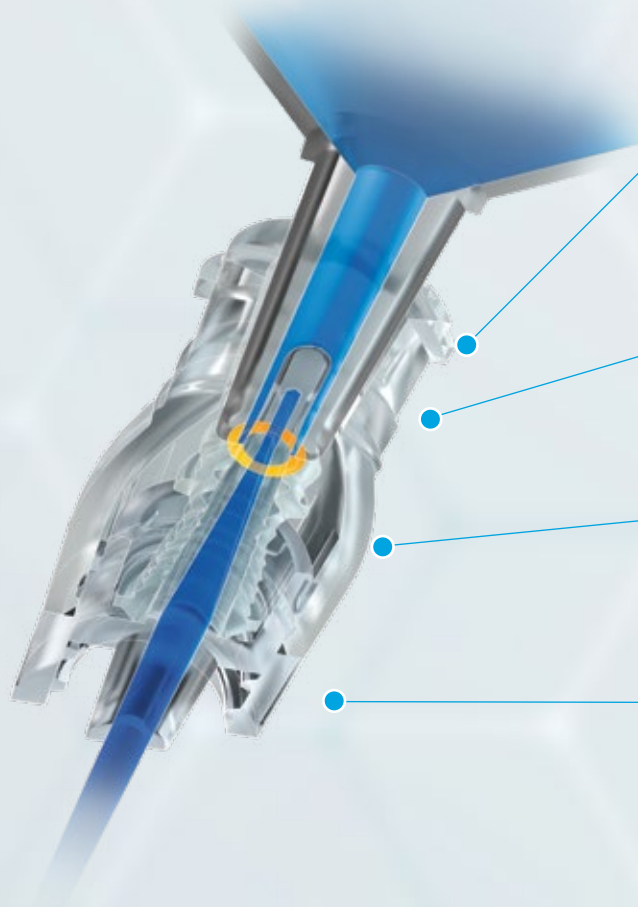

Smooth flat silicone surface for effective disinfection

Internal split septum design allows for a straight fluid pathway

Clear transparent housing to ensure all residue is fully flushed

Minimal residual volume allows for lower flush volumes

- The product is a needle-free connector with an integrated silicone seal that protects the patient and healthcare staff from needlestick accidents during intravenous therapy by minimizing needle usage.

Materials	Valve Body	Swabable Septum
Metal-free, Latex-free PVC-free	Copolyester	Silicone



## NEUTRAL DISPLACEMENT NEEDLE-FREE CONNECTORS



7-day antimicrobial  
ingress study available



Compatible with TPN  
solutions, blood and  
oncology drugs



Allows multiple  
accesses &  
suitable for high-  
flow rate infusion



Minimal volume  
required for flushing



Clear housing for  
visualization of fluid path



### A1010N

**NeutrArt® Needle-free Valve Neutral**

Priming Volume	Length	Flow Rate
0.04 ml	2.5 cm	160 ml/min



### AUWB1010N

**NeutrArt® Needle-free Valve With 4.0 mm OD Extension Line**

Priming Volume	Length	Flow Rate
0.46 ml	10 cm	95 ml/min



### AU1010N

**NeutrArt® Needle-free Valve Neutral with Extension Line**

Priming Volume	Length	Flow Rate
0.19 ml	10 cm	70 ml/min

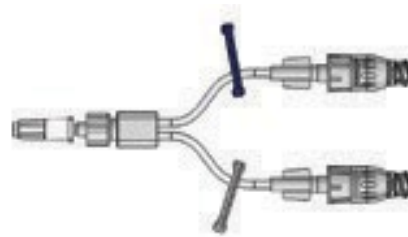

### A2010N

**NeutrArt® Double Lumen Needle-free Valve Neutral**

Priming Volume	Length	Flow Rate
0.42 ml	10 cm	70 ml/min

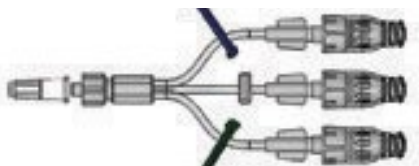

### A3010N

**NeutrArt® Triple Lumen Needle-free Valve Neutral**

Priming Volume	Length	Flow Rate
0.57 ml	10 cm	70 ml/min

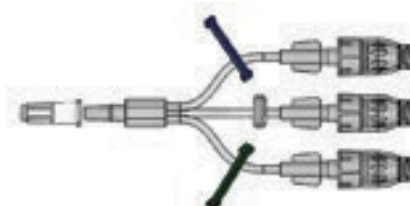

### A3010NWOR

**NeutrArt® Triple Lumen Needle-free Valve Neutral, Luer Slip**

Priming Volume	Length	Flow Rate
0.57 ml	10 cm	70 ml/min

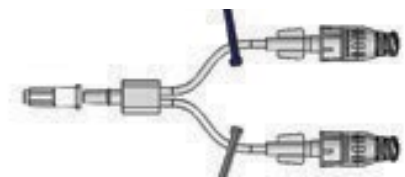

### A2010NWOR

**NeutrArt® Double Lumen Needle-free Valve Neutral, Luer Slip**

Priming Volume	Length	Flow Rate
0.42 ml	10 cm	70 ml/min



### ATU3010N

**NeutrArt® Needle-free Valve with Three Way Stopcock, Neutral**

Priming Volume	Length	Flow Rate
0.50 ml	15.5 cm	65 ml/min



# FlowArt®

Sterile Infusion Therapy Devices

FlowArt® is a Needle-free Valve that has a fully transparent clear housing with an integrated silicone seal and internal fluid pathway, that protects the patient and nursing staff from exposures.

Flat closed seal that provides a microbial barrier

Clear transparent housing to ensure residue is fully flushed

7-day antimicrobial ingress study available

Internal split septum allows for a straight smooth fluid pathway

Smooth flat silicone surface for effective disinfection

Universal compatibility with luer lock and luer slip connections

Suitable for high flow rate infusion

Suitable for TPN, blood and oncology infusions

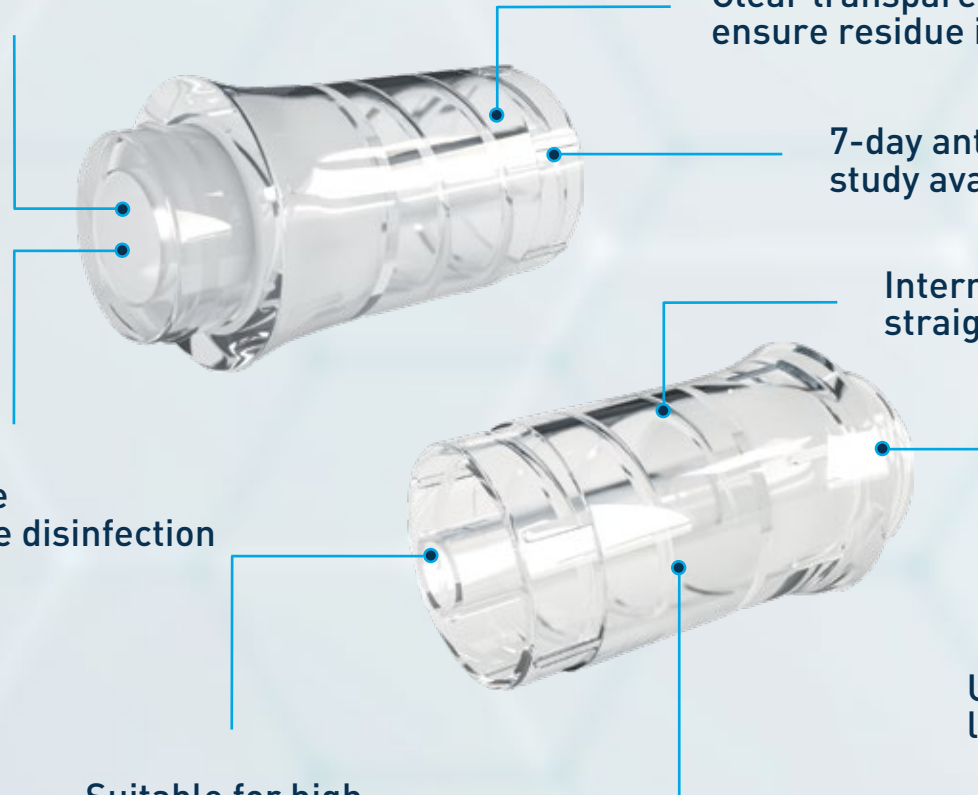





## IV INFUSION THERAPY SOLUTIONS

### Needle-free Valves

---

Reduces the risk of healthcare professional needlestick injury.

Protects healthcare professionals from blood contamination.

### I.V. Filters

---

Prevents the infusion of unwanted particles and organisms.

Retains particles, bacteria, fungi, yeast and air.

### Bag and Vial Adapters

---

Provides needle free fluid exchange with infusion bags and vials.

### Disinfecting Cap

---

SwabArt® Disinfecting Cap for swabable needle-free valves is a single-use disinfecting product that protects patients from infection.

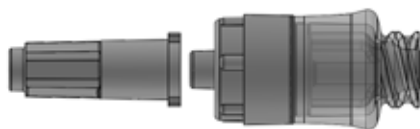

### A1010

**FlowArt®**  
Needle-free Valve Port

Priming Volume	Length	Flow Rate
0.085 ml	2.5 cm	312 ml/min 645 ml/min with pressure cuff



### AU1010

**FlowArt®** Needle-free Valve with  
Extension Line

Priming Volume	Length	Flow Rate
0.15 ml	8 cm	135 ml/min



### AUL1010

**FlowArt®** Needle-free Valve with  
Extension Line

Priming Volume	Length	Flow Rate
0.20 ml	16 cm	80 ml/min



### AUU1010L100

**FlowArt®** Needle-free Valve with  
Extension Line

Priming Volume	Length	Flow Rate
1 ml	100 cm	20 ml/min



### U1010

**FlowArt®** Needle-free Valve with  
Extension Line

Priming Volume	Length	Flow Rate
0.2 ml	8 cm	133 ml/min



### UU1010L150

**FlowArt®** Needle-free Valve with  
Extension Line

Priming Volume	Length	Flow Rate
1.5 ml	150 cm	17 ml/min



### UU1010L200

**FlowArt®** Needle-free Valve with  
Extension Line

Priming Volume	Length	Flow Rate
2 ml	200 cm	10 ml/min



### UWB1010L10

**FlowArt®** Needle-free Valve with  
Extension Line

Priming Volume	Length	Flow Rate
0.7 ml	10 cm	360 ml/min



### UWB1010L100

**FlowArt®** Needle-free Valve with Extension Line

Priming Volume	Length	Flow Rate
6.2 ml	100 cm	250 ml/min

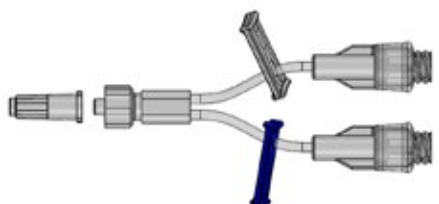

### A2010

**FlowArt®** Double Lumen Needle-free Valve Port

Priming Volume	Length	Flow Rate
0.35 ml	8.5 cm	100 ml/min



### A2010L15

**FlowArt®** Double Lumen Needle-free Valve Port

Priming Volume	Length	Flow Rate
0.40 ml	15 cm	95 ml/min

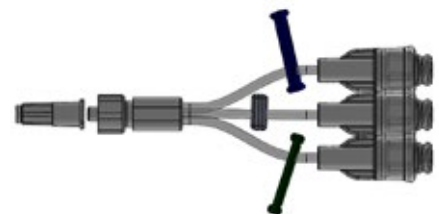

### A3010

**FlowArt®** Triple Lumen Needle-free Valve Port

Priming Volume	Length	Flow Rate
0.40 ml	8.5 cm	110 ml/min



### A3010YL15

**FlowArt®** Triple Lumen Needle-free Valve Port

Priming Volume	Length	Flow Rate
0.6 ml	15 cm	102 ml/min



### A2010Y

**FlowArt®** Double Lumen Valve with Y Connector

Priming Volume	Length	Flow Rate
0.70 ml	13.5 cm	325 ml/min



### A3010Y

**FlowArt®** Multi Y Connector

Priming Volume	Length	Flow Rate
1.35 ml	19.5 cm	330 ml/min



### A4010Y

**FlowArt®** Multi Y Connector

Priming Volume	Length	Flow Rate
1.65 ml	25.5 cm	345 ml/min



### A5010Y

FlowArt®  
Multi Y Connector

Priming Volume	Length	Flow Rate
2.30 ml	31.5 cm	320 ml/min



### A6010Y

FlowArt®  
Multi Y Connector

Priming Volume	Length	Flow Rate
2.85 ml	37.5 cm	315 ml/min

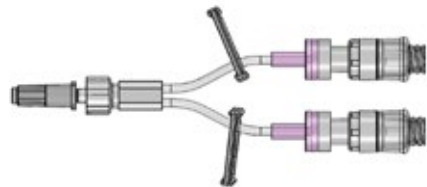

### A2010CV

FlowArt® Double Lumen Needle-free  
Valve Port with Check Valve

Priming Volume	Length	Flow Rate
0.45 ml	9,5 cm	90 ml/min



### A3010CV

FlowArt® Triple Lumen  
Check Valve

Priming Volume	Length	Flow Rate
0.75 ml	9.5 cm	95 ml/min



### 2010CV

FlowArt® Double Lumen  
Check Valve

Priming Volume	Length	Flow Rate
0.29 ml	8 cm	94 ml/min

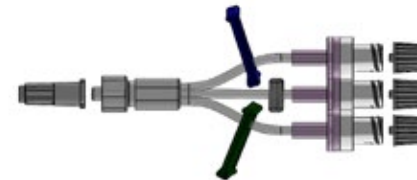

### 3010CV

FlowArt® Triple Lumen  
Check Valve

Priming Volume	Length	Flow Rate
0.40 ml	8 cm	105 ml/min

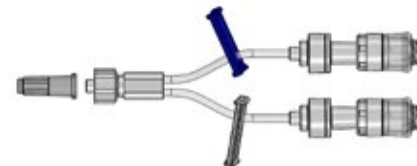

### A2010ASV

FlowArt® Double Lumen Anti-Siphon  
Valve with Swabable Valve

Priming Volume	Length	Cracking Pressure
0.60 ml	10 cm	3.5 PSI ± 1

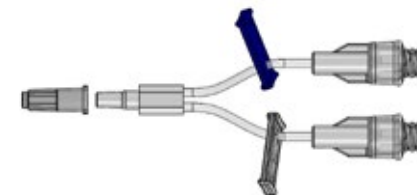

### A2010WOR

FlowArt® Double Lumen Needle-free  
Valve Port, Luer Slip

Priming Volume	Length	Flow Rate
0.25 ml	8.5 cm	90 ml/min

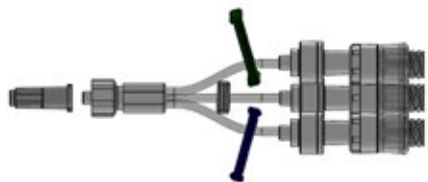

### A3010ASV

**FlowArt® Triple Lumen Anti-Siphon Valve with Swabable Valve**

Priming Volume	Length	Cracking Pressure
0.80 ml	10 cm	3.5 PSI $\pm$ 1

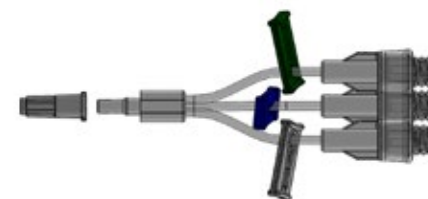

### A3010WOR

**FlowArt® Triple Lumen Needle-free Valve Port, Luer Slip**

Priming Volume	Length	Flow Rate
0.40 ml	8.5 cm	110 ml/min

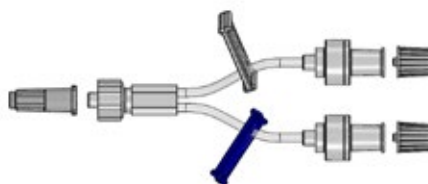

### 2010ASV

**FlowArt® Double Lumen Anti-Siphon Valve**

Priming Volume	Length	Cracking Pressure
0.30 ml	8 cm	3.5 PSI $\pm$ 1

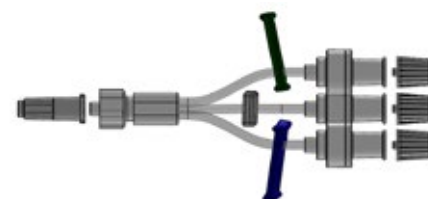

### 3010ASV

**FlowArt® Triple Lumen Anti-Siphon Valve**

Priming Volume	Length	Cracking Pressure
0.50 ml	8 cm	3.5 PSI $\pm$ 1



### 2010

**FlowArt® Double Lumen Extension Line**

Priming Volume	Length	Flow Rate
0.40 ml	18 cm	70 ml/min

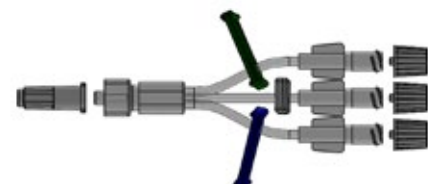

### 3010

**FlowArt® Triple Lumen Extension Line**

Priming Volume	Length	Flow Rate
0.35 ml	8 cm	115 ml/min



### AUWB1010

**FlowArt® Needle-free Valve with Extension Line 4.1 mm**

Priming Volume	Length	Flow Rate
0.45 ml	9 cm	295 ml/min



### AWB2010

**FlowArt® Wide Bore Double Lumen Needle-free Valve 4.1 mm**

Priming Volume	Length	Flow Rate
0.90 ml	14 cm	330 ml/min





### A4010

FlowArt® Quadruple Lumen  
Needle-free Valve

Priming Volume	Length	Flow Rate
0.8 ml	14 cm	85 ml/min



### AT3010

FlowArt® Needle-free Connector  
with Three Way Stopcock

Priming Volume	Length	Flow Rate
0.85 ml	5.5 cm	312 ml/min



### ATUWB3010

FlowArt® Needle-free Connector With  
Three Way Stopcock, Wide Bore

Priming Volume	Length	Flow Rate
1.2 ml	16.5 cm	320 ml/min



### ATU3010

FlowArt® Needle-free Connector  
with Three Way Stopcock

Priming Volume	Length	Flow Rate
0.50 ml	16.5 cm	100 ml/min



### ATU1010

FlowArt® Needle-free Connector  
with Three Way Stopcock

Priming Volume	Length	Flow Rate
0.65 ml	20 cm	100 ml/min



### AUWB1010T

FlowArt®  
Extension Line

Priming Volume	Length	Flow Rate
0.85 ml	11 cm	291 ml/min



### AUWB1010L20J

FlowArt®  
Extension Line

Priming Volume	Length	Flow Rate
1 ml	20 cm	220 ml/min



### F6002

FlowArt®  
0.2 Micron Filter

Priming Volume	Length	Flow Rate
2.55 ml	16 cm	40 ml/min



### F6012

FlowArt®  
1.2 Micron Filter

Priming Volume	Length	Flow Rate
2.30 ml	16 cm	110 ml/min

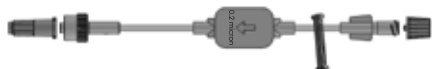

### F6002B

FlowArt®  
0.2 Micron Baby Filter

Priming Volume	Length	Flow Rate
0.45 ml	13 cm	8 ml/min



### F6002BET

FlowArt® 0.2 Micron Baby  
Endotoxin Filter

Priming Volume	Length	Flow Rate
0.45 ml	13 cm	2.5 ml/min

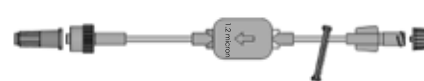

### F6012B

FlowArt®  
1.2 Micron Baby Filter

Priming Volume	Length	Flow Rate
0.40 ml	13 cm	25 ml/min



### AF6002

FlowArt® Needle-free Valve with  
0.2 Micron Filter

Priming Volume	Length	Flow Rate
3.0 ml	18 cm	F. L. 50 ml/min V. L. 240 ml/min



### AF6012

FlowArt® Needle-free Valve Set  
with 1.2 Micron Filter

Priming Volume	Length	Flow Rate
3.0 ml	18 cm	F. L. 170 ml/min V. L. 240 ml/min



### AF6002B

FlowArt® Needle-free Valve Set with  
0.2 Micron Baby Filter

Priming Volume	Length	Flow Rate
0.50 ml	12 cm	F. L. 7.5 ml/min V. L. 95 ml/min



### AF6012B

**FlowArt® Needle-free Valve Set with 1.2 Micron Baby Filter**

Priming Volume	Length	Flow Rate
0.50 ml	12 cm	F. L. 35 ml/min V. L. 95 ml/min



### AF6002ET

**FlowArt® Needle-free Valve Set with 0.2 Micron Endotoxin Filter**

Priming Volume	Length	Flow Rate
2.80 ml	18 cm	F. L. 42 ml/min V. L. 105 ml/min



### AF6002BET

**FlowArt® Needle-free Valve Set with 0.2 Micron Baby Endotoxin Filter**

Priming Volume	Length	Flow Rate
0.45 ml	12 cm	F. L. 5.5 ml/min V. L. 95 ml/min



### AF6102

**FlowArt® Single Set with 0.2 Micron Filter**

Priming Volume	Length	Flow Rate
2.40 ml	14 cm	50 ml/min

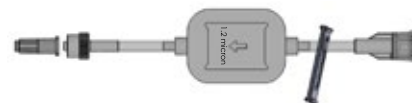

### AF6112

**FlowArt® Single Set with 1.2 Micron Filter**

Priming Volume	Length	Flow Rate
2.40 ml	14 cm	185 ml/min



### AF6102B

**FlowArt® Single Set with 0.2 Micron Baby Filter**

Priming Volume	Length	Flow Rate
0.30 ml	12 cm	6 ml/min



### AF6112B

**FlowArt® Single Set with 1.2 Micron Baby Filter**

Priming Volume	Length	Flow Rate
0.35 ml	12 cm	35 ml/min

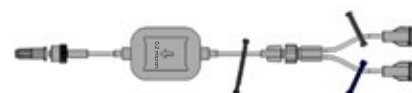

### AF6202

**FlowArt® Dual Port Set with 0.2 Micron Filter**

Priming Volume	Length	Flow Rate
1.80 ml	20 cm	24.5 ml/min

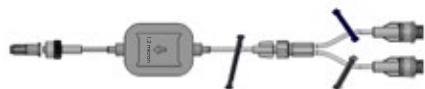

### AF6212

**FlowArt®** Dual Port Set with 1.2 Micron Filter

Priming Volume	Length	Flow Rate
2.50 ml	20 cm	90 ml/min



### AF6202B

**FlowArt®** Dual Port Set with 0.2 Micron Baby Filter

Priming Volume	Length	Flow Rate
0.60 ml	19 cm	6.5 ml/min



### AF6212B

**FlowArt®** Dual Port Set with 1.2 Micron Baby Filter

Priming Volume	Length	Flow Rate
0.6 ml	19 cm	35 ml/min



### AF6302

**FlowArt®** Triport Set with 0.2 Micron Filter

Priming Volume	Length	Flow Rate
2.95 ml	20 cm	40 ml/min

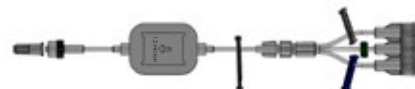

### AF6312

**FlowArt®** Triport Set with 1.2 Micron Filter

Priming Volume	Length	Flow Rate
2.50 ml	20 cm	85 ml/min



### AF6302B

**FlowArt®** Triport Set with 0.2 Micron Baby Filter

Priming Volume	Length	Flow Rate
0.65 ml	19 cm	8 ml/min



### AF6312B

**FlowArt®** Triport Set with 1.2 Micron Baby Filter

Priming Volume	Length	Flow Rate
0.75 ml	19 cm	30 ml/min



### AFY6202

**FlowArt®** Y Valve Dual Set 0.2 Micron Filter

Priming Volume	Length	Flow Rate
3 ml	26 cm	F. L. 300 ml/min V. L. 300 ml/min



### AFY6212

**FlowArt® Y Valve Dual Set 1.2**  
Micron Filter

Priming Volume	Length	Flow Rate
3.0 ml	26 cm	F. L. 90 ml/min V. L. 290 ml/min



### AFY6202B

**FlowArt® Y Valve Dual Set 0.2**  
Micron Baby

Priming Volume	Length	Flow Rate
0.70 ml	19 cm	F. L. 7 ml/min V. L. 95 ml/min



### AFY6212B

**FlowArt® Y Valve Dual Set 1.2**  
Micron Baby

Priming Volume	Length	Flow Rate
0.75 ml	19 cm	F. L. 30 ml/min V. L. 95 ml/min



### AFY6302

**FlowArt® Y Valve Triport Set 0.2**  
Micron Filter

Priming Volume	Length	Flow Rate
3.0 ml	26 cm	F. L. 25 ml/min V. L. 290 ml/min



### AFY6312

**FlowArt® Y Valve Triport Set 1.2**  
Micron Filter

Priming Volume	Length	Flow Rate
3.0 ml	26 cm	F. L. 95 ml/min V. L. 290 ml/min



### AFY6302B

**FlowArt® Y Valve Triport Set 0.2**  
Micron Baby Filter

Priming Volume	Length	Flow Rate
0.95 ml	19 cm	F. L. 6 ml/min V. L. 95 ml/min



### AFY6312B

**FlowArt® Y Valve Triport Set 1.2**  
Micron Baby Filter

Priming Volume	Length	Flow Rate
1.0 ml	19 cm	F. L. 28 ml/min V. L. 95 ml/min



### A2F6002B

**FlowArt® Double Lumen Filter Set**  
0.2 micron Baby

Priming Volume	Length	Flow Rate
0.70 ml	13 cm	8 ml/min





### A2F6012B

**FlowArt® Double Lumen Filter Set**  
1.2 micron Baby

Priming Volume	Length	Flow Rate
0.75 ml	13 cm	40 ml/min



### A3F6012B

**FlowArt® Triple Lumen Filter Set**  
1.2 micron Baby

Priming Volume	Length	Flow Rate
1.20 ml	13 cm	35 ml/min

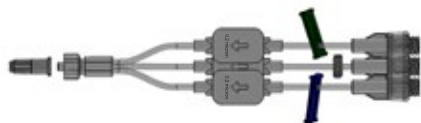

### A3F6002B

**FlowArt® Triple Lumen Filter Set**  
0.2 micron Baby

Priming Volume	Length	Flow Rate
1.10 ml	13 cm	8 ml/min

## TECHNICAL DRAWINGS AND SPECIFICATIONS | FlowArt® Bag and Vial Adapters

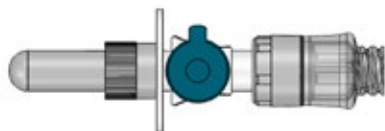

### ASM5010

**FlowArt® FlowArt Mini Spike with**  
Needleless Valve

Priming Volume	Length
0.11 ml	5.5 cm



### ASVY50CV

**FlowArt®**  
Fluid Transfer Set

Priming Volume	Length
2.45 ml	39 cm



### S5012

**FlowArt®**  
Transfer Spike

Priming Volume	Length
0.10 ml	8.5 cm



### ASY50

**FlowArt®**  
Spike Extension Set

Length
21.5 cm



### ASV5010

**FlowArt®** Valve for Bag  
Access Vented

Priming Volume	Length
0.47 ml	9 cm



### AV4020

**FlowArt®**  
Valve For Vial Access

Priming Volume	Length
0.08 ml	3 cm



### AS5010

**FlowArt®**  
Valve for Bag Access

Priming Volume	Length
0.45 ml	9 cm

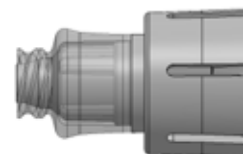

### AV4013

**FlowArt®** Valve For Vial Access,  
13 mm

Priming Volume	Length
0.06 ml	3 cm



### AS5011

**FlowArt®** Valve for Bag Access with  
Back Check Valve

Priming Volume	Length
0.80 ml	10.5 cm

# SwabArt<sup>®</sup>

## Disinfecting Cap

SwabArt<sup>®</sup> Disinfecting Cap for swabable needle-free valves is a single-use disinfecting product that protects patient from infection.

The product is impregnated with a high liquid absorbent sponge saturated with 70% Isopropyl Alcohol (IPA).

- » Provides active disinfection for up to 7 days if not removed
- » Compatible with the EN ISO 80369-7 standard
- » Compatible with all swabable needle-free valves
- » Sterile Latex-Free

- » Strip design allows hanging on drip poles
- » Supplied in boxes of 25 strip of 10 disinfecting caps
- » Supplied in boxes of 250 individual disinfecting caps
- » Shelf Life: 2 Years

Polyethylene Housing

Foam impregnated with 70% Isopropyl Alcohol (IPA) disinfects needle-free devices



Code	Product Description	Colour	Form	# of Caps	# of Strips/Box	Total Caps/Box
C100	SwabArt® Disinfecting Cap	Turquoise	Strip	10	25	250
C200	SwabArt® Disinfecting Cap	Turquoise	Individual Cap	1	-	250



[assetmedical.com](https://assetmedical.com)

NeutrArt®, FlowArt® and SwabArt® are registered trademarks of Asset Medical. Please see the Instructions for Use/Operator's Manual for a complete listing of the indications, contraindications, warnings and precautions. ©2022 Asset All rights reserved.



# 02

## SECTION

# OEM PRODUCTS



Needle-free Valve



Needle-free Valve for Tube Bonding



Y Site with Needle-free Valve

Photo Protective version of the products available upon request

### **BM01**

Needle Free Valve, Non Sterile

---



### **BM02-25**

Needle Free Valve, 2.5 mm ID,  
Non Sterile

---



### **BM02-28**

Needle Free Valve, 2.8 mm ID,  
Non Sterile

---



### **BM02-41**

Needle Free Valve, 4.1 mm ID,  
Non Sterile

---



### **BM04**

Y Site with Needle Free Valve,  
Non Sterile

---





# 03

## SECTION

---

# MEDICAL COMPONENTS



2 Way Connector



3 Way Connector



Male Luer Lock (MLL)



Slide Clamp



Female Cap



Luer Collar



Photo Protective version of the products available upon request

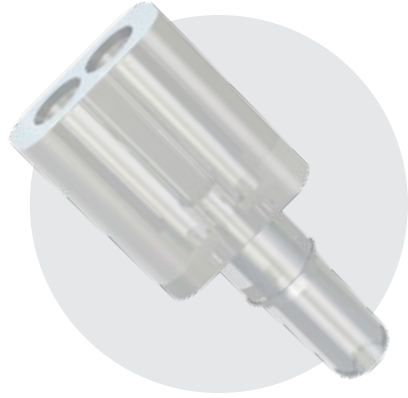

**K006-25**

Two Way Connector, 2.5 mm ID



**K007-25**

Three Way Connector, 2.5 mm ID

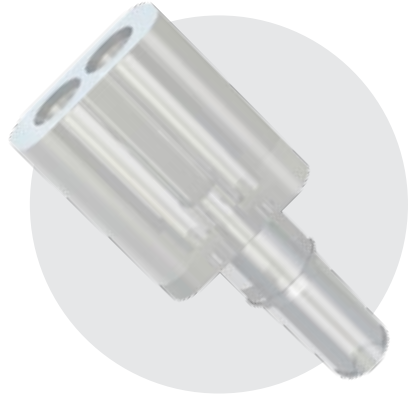

**K006-28**

Two Way Connector, 2.8 mm ID



**K007-28**

Three Way Connector, 2.8 mm ID



**K024-25**

Male Luer Lock (MLL) Connector,  
2.5 mm ID



**K024-41**

Male Luer Lock (MLL) Connector,  
4.1 mm ID



**K009**

Clamp  
Different color options are available



**K025**

Luer Collar



**K010**

Female Cap





[assetmedical.com](https://assetmedical.com)

NeutrArt®, FlowArt® and SwabArt® are registered trademarks of Asset Medical. Please see the Instructions for Use/Operator's Manual for a complete listing of the indications, contraindications, warnings and precautions. ©2022 Asset All rights reserved.

# 04

## SECTION

---

# USER'S GUIDE



FlowArt® NeutrArt® Needle-free IV Connectors User's Guide

### 01. Prepare Needle-free valve

Prior to every access, swab the surface of FlowArt® valve with a proper antiseptic wipe 1-2 seconds and allow to dry approximately 30 seconds.



### 02. Connect the syringe or infusion set to the valve

Insert the syringe or the infusion set into the valve with a 90° clockwise motion.



### 03. Close the clamp

To hinder any reflux in the catheter, apply clamp before disconnecting syringe.



### 04. Remove the syringe from the valve

Remove the luer from the valve by turning counter clockwise.





Screw attach valve to IV Cannula.



Insert the syringe tip into the valve. If syringe has a male luer lock collar, turn syringe clockwise to secure the connection. If syringe has a slip luer, insert and rotate 90° to secure the connection. Do not leave slip luer syringes unattended.

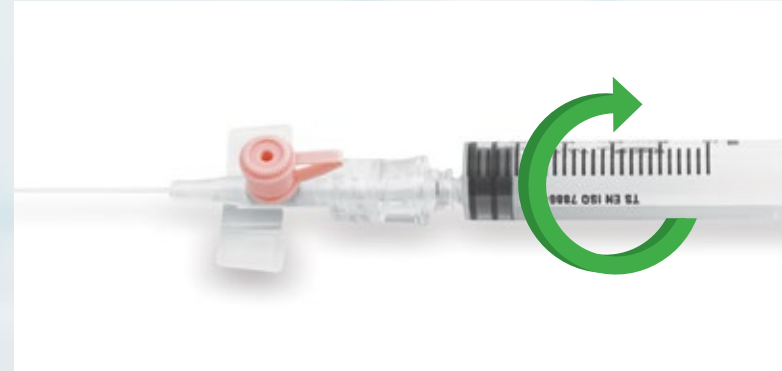

Do not try to use a needle as it can damage the silicone part of the valve.

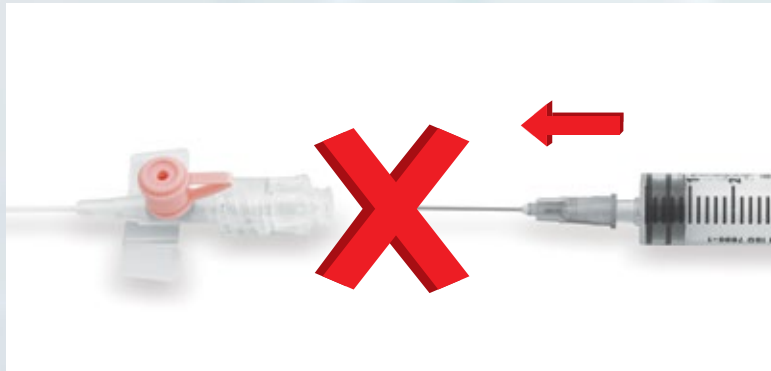

After injection, disconnect the syringe by rotating. Fluid pathway will be automatically closed. This will eliminate blood contact and need of cap.

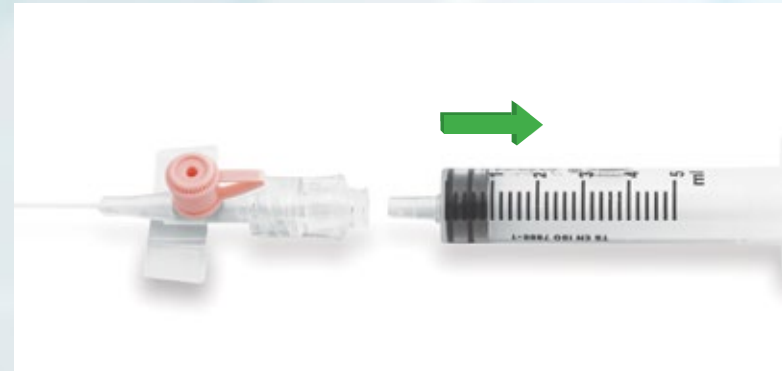







Asset® Medical Design, Inc.

İkitelli Organize Sanayi Bölgesi Mahallesi

17. Cadde No:17, 34480 Başakşehir, İstanbul / Turkey

Phone: +90 212 494 27 27

info@assetmedical.com

www.assetmedical.com

**NeutrArt®**  
Neutral Displacement Needle-Free Connectors

**FlowArt®**  
Sterile Infusion Therapy Devices

**SwabArt®**  
Disinfecting Cap